

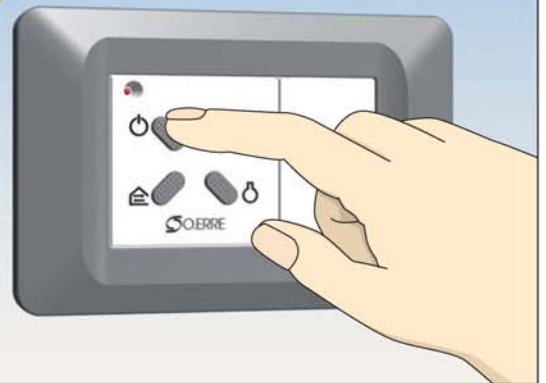

COMMERCIAL FANS

SMART 23/9 & 30/12 Wi Fi



Model	Ref.
SMART 23/9 Wi-Fi	OW 716 3
SMART 30/12 Wi-Fi	OW 718 9

The fan, operated by a wireless radio control (Wi-Fi) and only requires the connection to the electric systems (L-N).

The remote control (included) is supplied with 12V DC battery and fully operates the product's functions (on-off, reversibility and 3 speed regulation).

The remote control can easily be installed to the wall or panel with two small screws.

Being a radio transmitting control, it is not necessary to point it directly towards the fan and operates within a maximum range of 30 meters.

The polished design of the Wi-Fi radio transmitter perfectly integrates with the other elements of the electric installation.